

# Spare Mezzanine RAID Card Instructions

This document describes how to remove and replace a mezzanine RAID controller card in a NEO 80 or 160 Agility appliance from Overland Storage.

**WARNING:** To reduce the risk of electric shock or damage to equipment, always remove any power cords while working with the appliance.

**WARNUNG:** Um das Risiko eines elektrischen Schlags oder Schäden am Gerät zu vermeiden, ziehen Sie stets den Netzstecker, bevor Sie an der Einheit arbeiten.

**AVERTISSEMENT:** Pour réduire le risque de choc électrique ou endommagement de l'équipement, retirez toujours les cordons électriques en travaillant avec l'appareil.



**CAUTION:** While working with the appliance, observe standard Electrostatic Discharge (ESD) precautions to prevent damage to micro-circuitry or static-sensitive devices.

## Prepare the Appliance

### Power Appliance Off

**CAUTION:** To prevent data corruption and loss, verify that all processes are inactive and idle before shutting down the NEO Agility appliance.

- Using either console or remote desktop, log into the appliance as an **administrator**.
- Verify that all host processes are **idle**.
- From the **Agility Management Console**, verify that all queued tape write operations have completed.  
Review the last entries in the **Diagnostics > System** log for the **Flush Cache > SUCCEEDED** events for all tape drives.
- Right-click the Windows logo in the lower-left corner and select **Shutdown or sign out > Shutdown**.
- When all the LEDs are off, disconnect the **power cords** from their sockets.
- Disconnect the remaining **cables** from the unit, noting their locations.

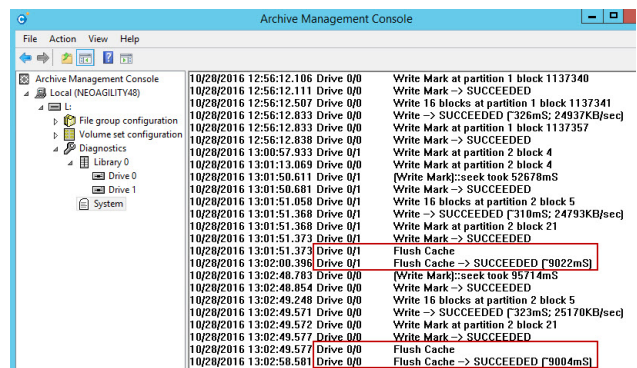

### Remove the Bezel

- If needed, use the **supplied key** to unlock the bezel.
- Press in the **latch** on the right to release the bezel.
- Carefully swing the **bezel** out, remove it from the appliance, and set it aside.



## Remove the Drives

**IMPORTANT:** Overland recommends that you remove the disk drives to reduce the unit's weight prior to removal.

**NOTE:** Do not remove the disk drives from their carriers. Doing so voids the drive warranty.

Remove **all** the drive and blank carriers noting from which bay they were removed:

1. Press the **button** on the right side of the carrier to release the built-in handle.
2. Using the **handle**, pull the carrier out.
3. **Number the carrier** and set it on a secure surface.
4. Repeat [Steps 1–3](#) for **all** the remaining drive carriers.

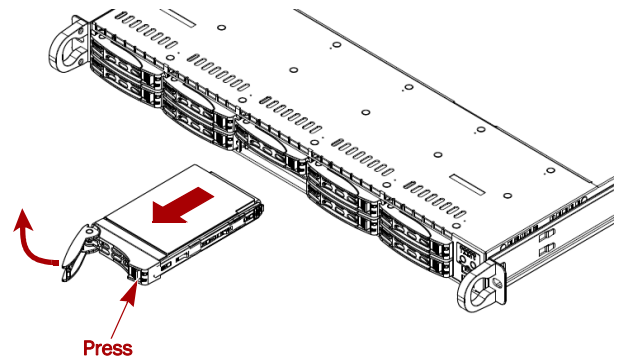

## Remove Unit from Rack

**WARNING:** It is recommended that a mechanical lifter (or at least two people) be used during rack installation or removal to prevent injury.

**WARNUNG:** Um Verletzungen zu vermeiden, empfehlen wir zur Rack-Installation oder -Deinstallation die Nutzung einer mechanischen Hebehilfe (oder mindestens zwei Personen).

**AVERTISSEMENT:** Pour éviter toute blessure il est recommandé qu'un monte-charge (ou deux personnes au moins) soit utilisé lors de l'installation ou de l'enlèvement du support.

1. Remove and retain the **two screws** on the front flanges that secure the appliance to the rack.
2. With a lifter positioned in front of the appliance, fully extend the rails to slide the **chassis** out onto the lifter.
3. Depress the **rail locking tabs** on each side to release the appliance and place it onto the lifter.
4. Place the chassis on a **secure surface**.

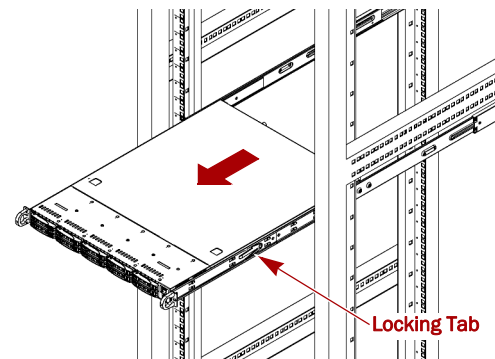

## Remove Top Panel

1. With the appliance on a secure surface, release the captive screw at the rear of the top panel.
2. **Slide the top panel** toward the rear and lift it off. Only about **one-half inch** (1.25cm) movement is required.
3. Repeat [Steps 1–2](#) for the **new chassis**.

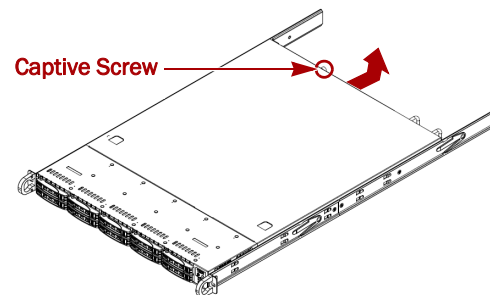

## Install/Replace Mezzanine Card

### Remove Existing Mezzanine Card

Note both the **orientation** and **location** of card in chassis.

1. Loosen the **latches** securing the two tie-wrapped cables to the mezzanine card.
 

*NOTE: Do not cut the cable tie-wraps during this procedure.*
2. Disconnect the **two cables** from the mezzanine card.
3. Use a Phillips screwdriver to remove and retain the **three screws** securing the mezzanine card to the chassis.
4. With both hands, lift the **card** up by its corners to unseat it from the chassis, setting it aside for return to Overland.

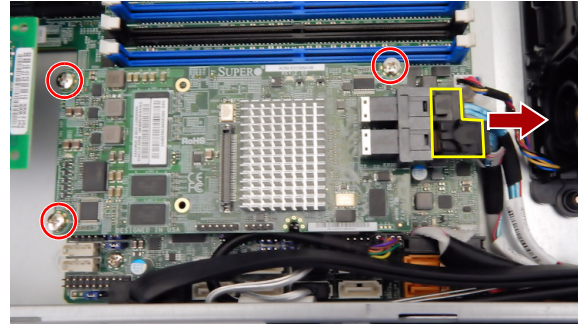

### Install New Mezzanine Card

1. With both hands, carefully seat the **new card** in the slot.
2. Using a Phillips screwdriver, attach the mezzanine card to the chassis with the **three retained screws**.
3. Connect the previously removed **two cables** in the same order as before to the new mezzanine card.

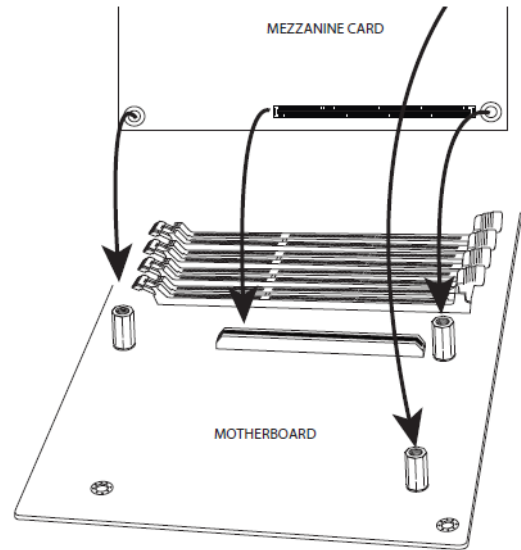

## Complete the Replacement

### Reinstall Top Panel

1. Align the top panel over the appliance with no more than **one-half inch** (1.25cm) extending out over the rear and gently press it down onto the appliance.
2. Slide the panel **forward** into position.
3. Tighten the **captive screw** at the rear of the panel to ensure it is securely seated.

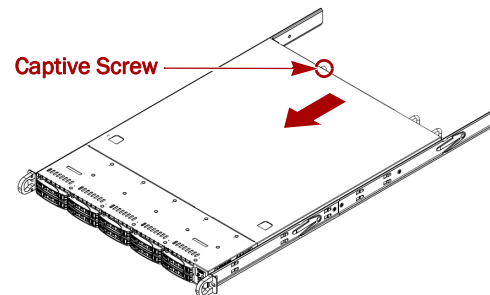

## Reinstall Appliance in Rack

1. Fully extend the **outer rails** from the rack to the front.
2. Using the mechanical lifter, position the **appliance** in front of the rack, aligning the **inner rails** with the rack **outer rails**.
3. Slide the chassis into the rail racks, keeping the pressure even on both sides, until the **locking tabs** click into place.

**NOTE:** You may need to depress the locking tabs when reinstalling the appliance to ensure they are securely seated.

4. Reinstall the retained **two screws** in the front appliance flanges to secure the appliance to the rack.

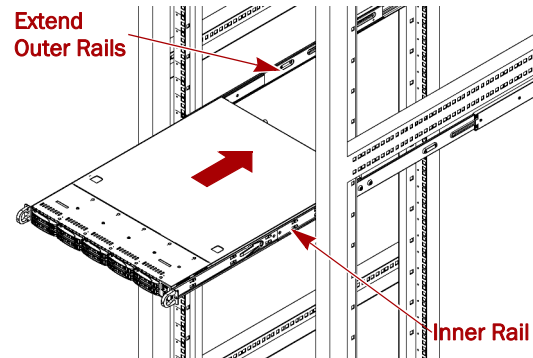

## Reinstall Drives

1. Position a **drive assembly** in front of its empty **bay**. They **MUST** be returned to the bay they were removed from. Refer to the number on the assembly.
2. Slide the **assembly** in until it stops.
3. Press the **handle** in until the latch **clicks**, securing it.
4. Repeat **Steps 1–3** for **all** remaining drive carriers.

**IMPORTANT:** To maintain proper airflow and cooling, a drive assembly or a blank carrier must be installed in every bay. No empty bays are allowed.

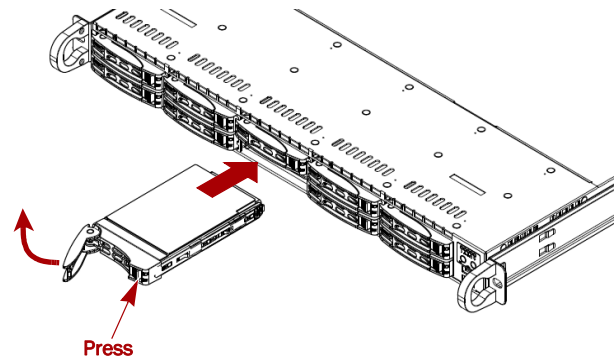

## Attach the Bezel

1. Holding the bezel level horizontally and at a 45° angle to the front, insert the **left bezel tabs** into the left flanges.
2. Pressing in the release latch on the right, swing the **bezel** into place on the right, and let go the latch to secure it.
3. If needed, **lock** the bezel using the supplied key.

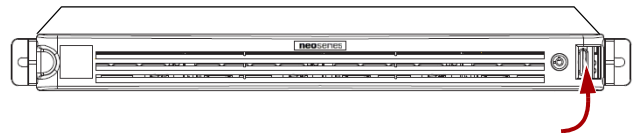

## Reconnect Cables and Power On

1. Reconnect **fibre channel (FC) or SAS cables** from the FC/SAS ports on the NEO library tape drives to the NEO Agility appliance.

**NOTE:** For FC environments, the interconnect may be from an FC switch.

2. Reconnect the **network cables** to the Ethernet ports.
3. If required for **console connection**, reattach a video monitor cable to the VGA port and keyboard/mouse cable to a USB port.
4. If needed, use the **IPMI port** for hardware monitoring.
5. Reattach both **power cords** to the AC power sockets on the appliance.
6. Plug the **power cords** into a UPS appliance or a properly grounded AC power source.
7. Press the **power switch** to power the appliance back ON.

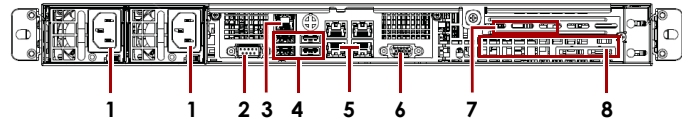

- |                       |                                       |
|-----------------------|---------------------------------------|
| 1 - AC Power          | 5 - 1GbE Port (2)                     |
| 2 - VGA Port          | 6 - Serial Port                       |
| 3 - IPMI Port         | 7 - FC (80/160 only) or SAS Ports (2) |
| 4 - USB 3.0 Ports (4) | 8 - Optional card                     |

## Return Old Parts to Overland

1. Place the **old part** in the anti-static bag and put it in the replacement part's box.
2. Use the existing **packing material** to secure it in the box.
3. Use an RMA to return the part to **Overland Storage**.

For return shipping details and RMA number, go to:  
<http://docs.overlandstorage.com/return-instructions>.

